

TJERNLUND AIDS WOOD BURNING STOVES WITH **AUTO-DRAFT®**

MAXIMUM ENERGY EFFICIENCY FAST FIRES WITHOUT SMOKE

With Auto-Draft® your hard starting stove draws immediately. No smoky back up even with moist or hard to ignite types of wood. Once the fire is burning, adjust the variable speed control knob on electrical box for maximum efficiency of your stove. Auto-Draft provides for total utilization of your wood, leaving only a fine ash residue in most cases.

MODEL AD-1 ADVANTAGES

- Eliminates smoke
- Fast starting fires
- Maximum utilization of fuel
- Broadens range of fuels that can be used
- Works on standard 115 VAC
- Easy to install
- Heavy duty construction
- Minimal maintenance
- Rich flat black heat resistant finish

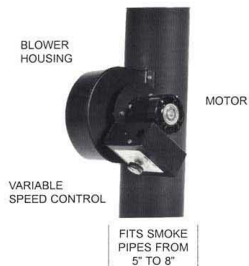

SPECIFICATIONS

DIMENSIONS		ELECTRICAL	
Height	9 1/2"	Voltage	115/1/60
Width	9"	Motor RPM	1200 - 1600
Depth	7"	Motor HP	1/70 (open)
Ship	10 Lbs.	Motor Amps	1 (max.)



FITS MOST WOOD OR COAL BURNING STOVES

Auto-Draft can be installed on any wood or coal burning stove pipe from 5" to 8" in diameter. Designed to solve draft problems without increasing height or diameter of the chimney

EASY TO INSTALL

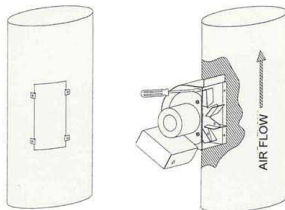

1. Cut 8 5/8" x 3 1/8" slot in the stove smoke pipe using template included. Install speed clips.
2. Secure unit to smoke pipe with sheet metal screws supplied. Simply tie into 115 VAC in accordance with prevailing codes.